

# 911 ADDRESSES TODD COUNTY, MINNESOTA SYLVAN SHORES AREA

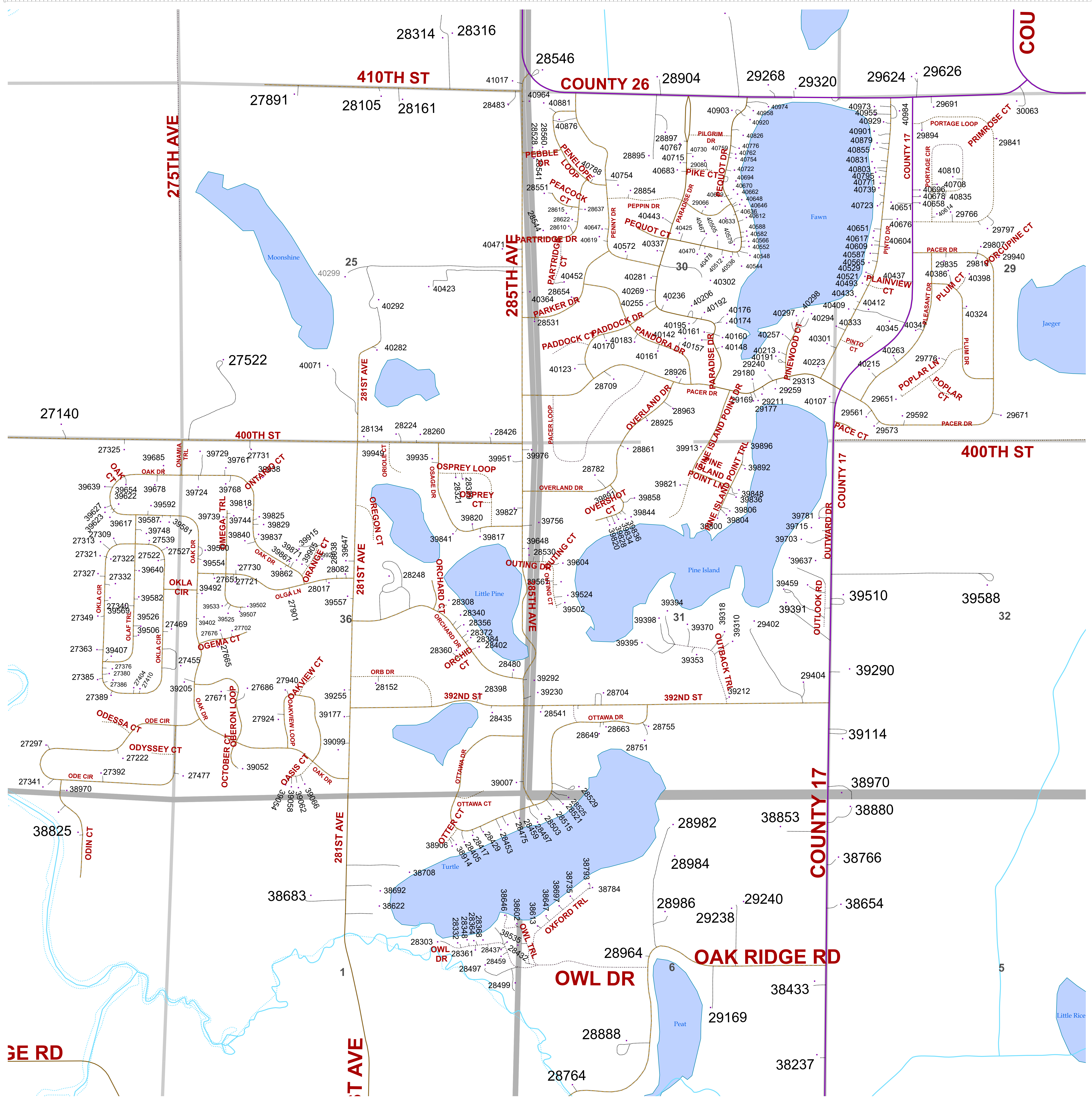

1:6,000



GIS & Land Services  
215 1st Ave S - Suite 102  
Long Prairie, MN 56347  
(phone) 320-732-4248  
(fax) 320-732-4803  
www.co.todd.mn.us  
Date: Apr 01, 2024

- |               |                    |                  |              |      |
|---------------|--------------------|------------------|--------------|------|
| Interstate    | CSAH-Gravel        | TWP-Gravel       | Driveway     | Lake |
| U.S. Highway  | County Road-Paved  | Min. Maintenance | Address Site | City |
| State Highway | County Road-Gravel | Municipal        | Section      |      |
| CSAH-Paved    | TWP-Paved          | Private Road     | Stream       |      |

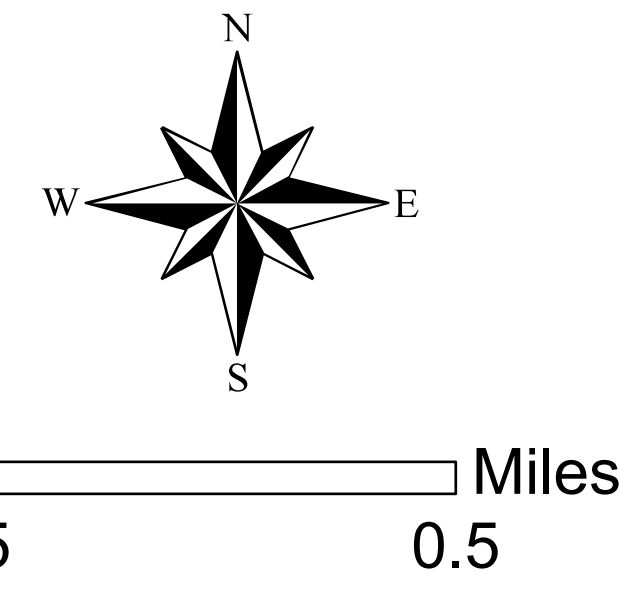

The Todd County GIS & Land Services Department has made every effort to provide the most accurate and up-to-date information available in this publication and cannot be held responsible for any unforeseen errors or omissions. If the recipient wishes to locate parcel corners and property lines, employ the services of a Registered Land Surveyor.