

Todd County, Minnesota

E911 Address Locations

TOWNSHIP: VILLARD T133N R32 W

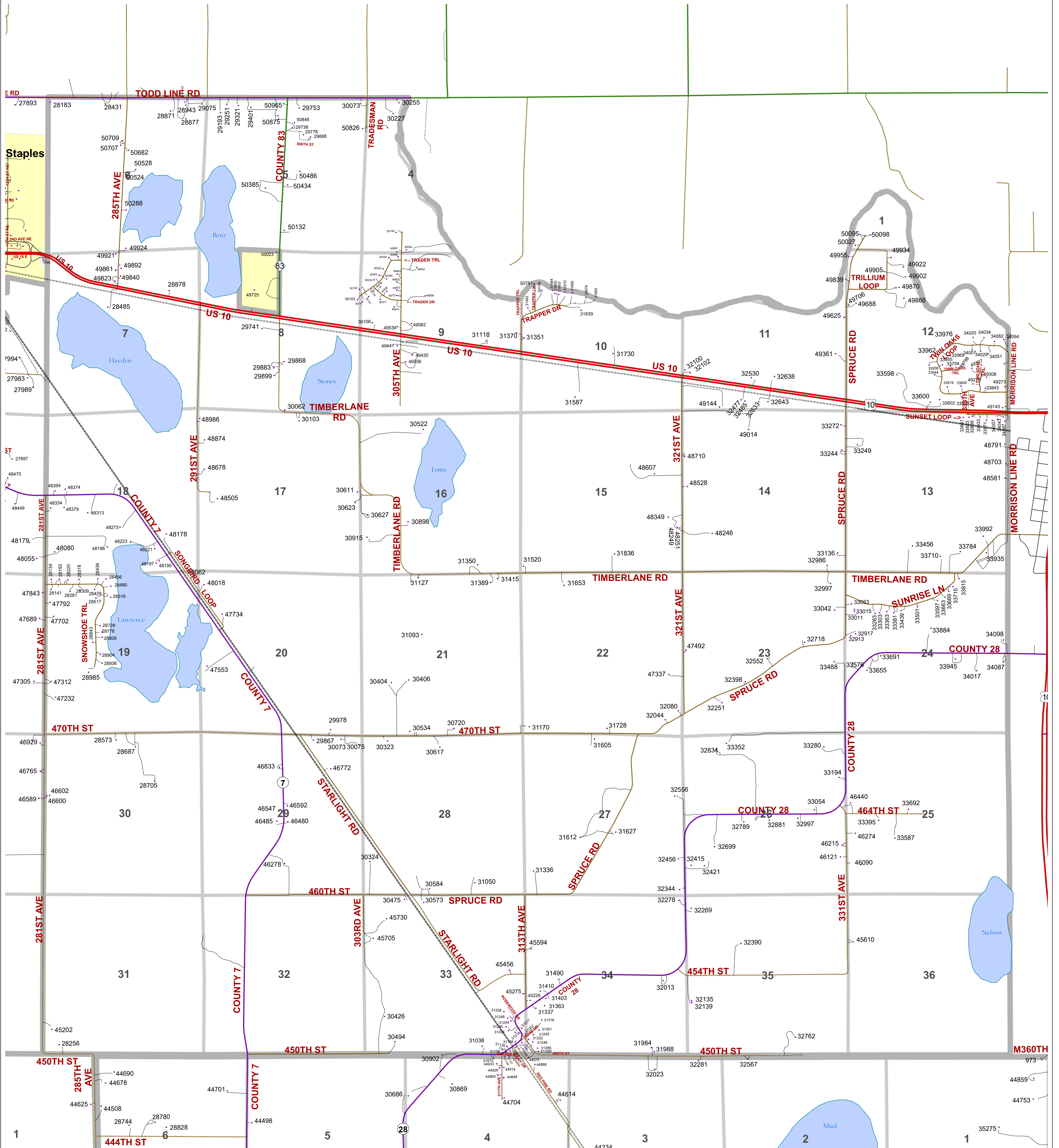

Todd County



Todd County GIS
215 1st Ave S - Suite 102
Long Prairie, MN 56347
320-732-4248
www.co.todd.mn.us

Created: April 2024

Interstate

U.S. Highway

State Highway

CSAH-Paved

CSAH-Gravel

County Road-Paved

County Road-Gravel

TWP-Paved

1:13,000

TWP-Gravel

Min. Maintenance

Municipal

Private Road

Address Site

Driveway

Lake

Stream

City

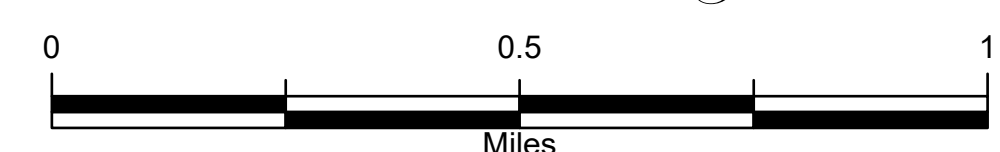

The Todd County GIS
Department has made every effort to
provide the most accurate and
up-to-date information available in this
publication and cannot be held responsible
for any unforeseen errors or omissions.